

## Datasheet

# 2-port Gigabit Single-mode Dual Fiber Media Converter

## SUN-1110-SCX-O / SUN-1110-MCX-O



SUN-1110-SCX-O / SUN-1110-MCX-O è un media converter in fibra gigabit. Dispone di 1 porta 10/100/1000Base-T e 1 porta in fibra SC/LC uplink 1000M. L'utente può utilizzare diversi moduli ottici, come la doppia fibra multimodale, la doppia fibra monomodale e la singola fibra monomodale. Il convertitore multimediale adotta la soluzione di livello enterprise della società di Taiwan Realtek.

### ■ Gigabit photoelectric Ethernet conversion transmission

- ◇ Support gigabit RJ45 port and gigabit fiber port combination, which enables users to flexibly build networking to meet the needs of various scenarios.
- ◇ Support non-blocking wire-speed forwarding.

- ◇ Support full-duplex based on IEEE802.3x and half-duplex based on Backpressure.

■ **Easy to use and simple to maintain**

- ◇ Compatible with IEEE802.3ab 1000Base-T, IEEE802.3z 1000Base-X network protocol, gigabit R45 port rate auto-negotiation
- ◇ Support full-duplex/half-duplex working mode with auto-negotiation function
- ◇ Automatic identification of twisted pair MDI/MDI-X cross lines and parallel lines
- ◇ Plug and play, no configuration required, centralized power supply and centralized connection management through 2U-14 slot rack
- ◇ LED working status indication for network diagnosis and fault checking, reducing maintenance workload.

■ **Stable and reliable**

- ◇ Low power consumption, No fan , galvanized steel casing.
- ◇ CCC, CE, FCC, RoHS.
- ◇ Comply with telecommunication network access requirements, and have the telecommunications equipment network access license of the MIIT.

## TECHNICAL SPECIFICATION

Model	SUN-1110-MCX-O	SUN-1110-SCX-O	SUN-1110S-SCX-O-A/B
<b>Interface Characteristics</b>			
Interface	1* 10/100/1000Base-T RJ45 port (Data) 1*1000M uplink SC/LC fiber port (Data)		
Ethernet Port	10/100/1000Base-T, auto-sensing, Full/half duplex MDI/MDI-X self-adaption		
Twisted Pair Transmission	10BASE-T: Cat3,4,5 UTP(≤100 meter) 100BASE-TX: Cat5 or later UTP(≤100 meter) 1000BASE-T: Cat5e or later UTP(≤100 meter)		
Optical Fiber Port	1.25Gbps, multi-mode dual fiber SC port	1.25Gbps, single-mode dual fiber SC	1.25Gbps, single-mode single fiber SC port

	port
Optical Cable/ Distance	Multi-mode: 850nm / 0 ~ 500m, 1310nm / 0 ~ 2km; Single-mode: 1310nm / 0 ~ 40km, 1550nm 0 ~ 120km.
<b>Chip Parameter</b>	
Network Protocol	IEEE802.3 10BASE-T, IEEE802.3i 10Base-T, IEEE802.3u 100Base-TX IEEE802.3ab 1000Base-T, IEEE802.3z 1000Base-X, IEEE802.3x
Forwarding Mode	Store and forward(Full wire speed)
Switching Capacity	2.0Gbps (Non-blocking)
Forwarding Rate@64byte	3.0Mpps
MAC	2K
Buffer Memory	1M
Jumbo Frame	1632byte
LED Indicator	Power: PWR (Green), ON/OFF, Data: L/A (Green): ON/OFF/Blink, Half/full duplex: FDX (Green) , ON/OFF, Speed: 100/1000 (Green) ,ON/OFF
<b>Power Supply</b>	
Total PWR / Input Voltage	3.5W/(5VDC)
Power Consumption	Standby<1W,Full Load<4W
<b>Physical Parameter</b>	
Operation TEMP / Humidity	-20~+55°C, 5%~90% RH Non condensing
Storage TEMP / Humidity	-40~+85°C, 5%~95% RH Non condensing
Dimension (L*W*H)	94*71*26mm
Net /Gross Weight	<0.3kg / <0.5kg
Installation	Desktop, 2U-14 Rack-mounted
<b>Certification &amp; Warranty</b>	
Lightning	Lightning protection: 4KV 8/20us, Protection level: IP30

Protection	
Certification	CCC, CE mark, commercial, CE/LVD EN60950, FCC Part 15 Class B, RoHS

## DIMENSION

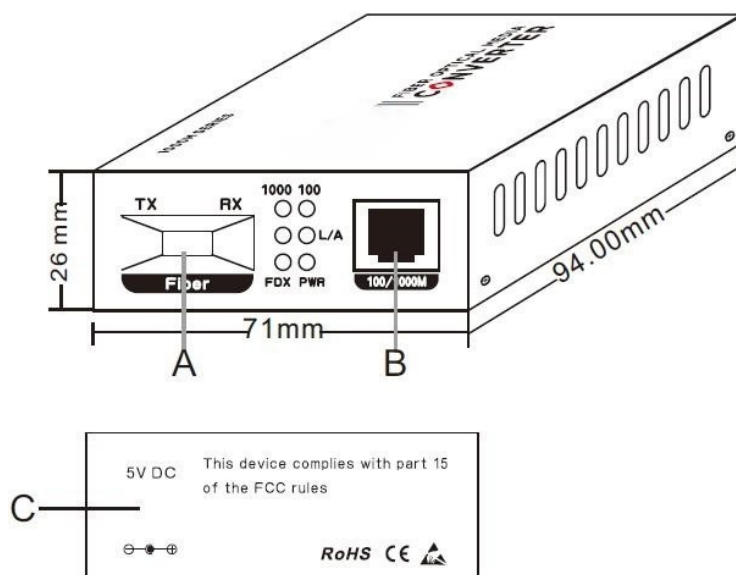

A. 1.25G SC fiber port  
C. DC5V power input port

B. 1\*10/100/1000M RJ45 port

## APPLICATION

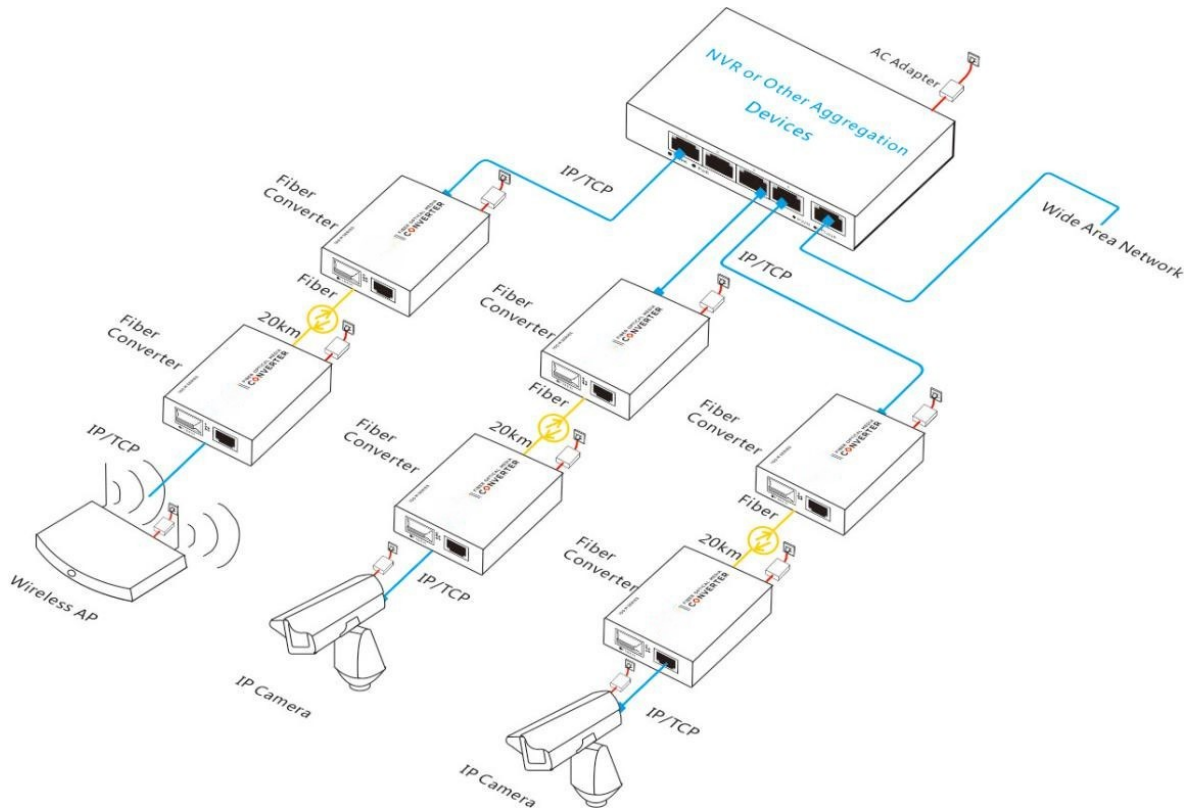

## ORDERING INFORMATION

Model	Description
SUN-1110-MCX-O	Gigabit <b>multi-mode dual fiber</b> media converter with 1*10/100/1000M RJ45 port and 1*1.25G SC fiber port. Total power is 4W, 850nm wavelength, default transmission distance 0-550m. External power supply: AC100-240V input.
SUN-1110-SCX-O	Gigabit <b>single-mode dual fiber</b> media converter with 1*10/100/1000M RJ45 port and 1*1.25G SC fiber port. Total power is 4W, 1310nm wavelength, default transmission distance 0-20km. External power

	supply: AC100-240V input.
SUN-1110S-SCX-O-A	Gigabit <b>single-mode single fiber</b> media converter with 1*10/100/1000M RJ45 port and 1*1.25G SC fiber port. Total power is 4W, 1310nm wavelength, default transmission distance 0-20km. External power supply: AC100-240V input.
SUN-1110S-SCX-O-B	Gigabit <b>single-mode single fiber</b> media converter with 1*10/100/1000M RJ45 port and 1*1.25G SC fiber port. Total power is 4W, 1550nm wavelength, default transmission distance 0-20km. External power supply: AC100-240V input.
SUN-1110-MCX-K	Gigabit <b>multi-mode dual fiber</b> media converter with 1*10/100/1000M RJ45 port and 1*1.25G SC fiber port. Total power is 4W, 850nm wavelength, default transmission distance 0-550m. Support one-click switch LFP enable and store-forward / pass-through forwarding. External power supply: AC100-240V input.
SUN-1110-SCX-K	Gigabit <b>single-mode dual fiber</b> media converter with 1*10/100/1000M RJ45 port and 1*1.25G SC fiber port. Total power is 4W, 1310nm wavelength, default transmission distance 0-20km. Support one-click switch LFP enable and store-forward / pass-through forwarding. External power supply: AC100-240V input.
SUN-1110S-SCX-K-A	Gigabit <b>single-mode single fiber</b> media converter with 1*10/100/1000M RJ45 port and 1*1.25G SC fiber port. Total power is 4W, 1310nm wavelength, default transmission distance 0-20km. Support one-click switch LFP enable and store-forward / pass-through forwarding. External power supply: AC100-240V input.
SUN-1110S-SCX-K-B	Gigabit <b>single-mode single fiber</b> media converter with 1*10/100/1000M RJ45 port and 1*1.25G SC fiber port. Total power is 4W, 1550nm wavelength, default transmission distance 0-20km. Support one-click switch LFP enable and store-forward / pass-through forwarding. External power supply: AC100-240V input.

SUN-1110-MLX-F	Gigabit <b>multi-mode dual fiber</b> media converter with 1*10/100/1000M RJ45 port and 1*1.25G SFP fiber port. Total power is 4W, 850nm wavelength, default transmission distance 0-550m. External power supply: AC100-240V input.
SUN-1110-SLX-F	Gigabit <b>single-mode dual fiber</b> media converter with 1*10/100/1000M RJ45 port and 1*1.25G SFP fiber port. Total power is 4W, 1310nm wavelength, default transmission distance 0-20km. External power supply: AC100-240V input.
SUN-1110S-SLX-F-A	Gigabit <b>single-mode single fiber</b> media converter with 1*10/100/1000M RJ45 port and 1*1.25G SFP fiber port. Total power is 4W, 1310nm wavelength, default transmission distance 0-20km. External power supply: AC100-240V input.
SUN-1110S-SLX-F-B	Gigabit <b>single-mode single fiber</b> media converter with 1*10/100/1000M RJ45 port and 1*1.25G SFP fiber port. Total power is 4W, 1550nm wavelength, default transmission distance 0-20km. External power supply: AC100-240V input.

**SUNELL ITALIA STARK SOLUTION**

**Via 3° Strada n°36 Zona Industriale 95121 Catania (CT)**

[info@sunellitalia.net](mailto:info@sunellitalia.net)